

### 750 Steckschlüssel

Impact sockets





Antrieb: 1" Innenvierkant  
DIN 3121 - H 25

Drive: 1" square

DIN 3121 - H 25

Abtrieb: Innensechskant DIN/ISO 691

Tip: Hexagon DIN/ISO 691

Code	SW	L	D1	D2	T		
075000	19	58	35,5	54	17,0	629	1
075001	21	58	37,5	54	17,0	640	1
075002	22	58	40,0	54	17,0	661	1
075003	24	58	42,0	54	17,0	592	1
075004	27	58	46,0	54	17,0	682	1
075005	28	58	47,0	54	17,0	666	1
075006	29	60	48,0	54	19,0	595	1
075007	30	60	50,0	54	21,0	714	1
075008	32	60	52,0	54	21,0	685	1
075009	33	60	53,0	54	21,0	676	1
075010	34	62	55,0	54	21,0	726	1
075011	36	65	56,0	54	30,0	756	1
075012	38	65	59,0	54	30,0	815	1
075013	39	67	60,0	54	31,0	795	1
075014	41	67	63,0	54	31,0	846	1
075015	46	74	69,5	54	36,0	1133	1
075016	50	80	74,0	54	42,0	1312	1
075017	55	84	81,0	54	44,0	1479	1
075018	60	87	87,0	54	44,0	1727	1
075019	65	90	93,0	54	46,0	1981	1
075020	70	96	100,0	54	51,0	2271	1
075021	75	98	104,0	86	52,0	3622	1
075022	80	100	109,0	86	52,0	3539	1
075023	85	100	115,0	86	52,0	4440	1
075024	90	105	119,0	86	55,0	4845	1
075025	95	105	130,0	86	55,0	5629	1
075026	100	105	136,0	95	55,0	6340	1

### 750 L Steckschlüssel - lange Ausführung

Impact sockets





Antrieb: 1" Innenvierkant  
DIN 3121 - H 25

Drive: 1" square

DIN 3121 - H 25

Abtrieb: Innensechskant DIN/ISO 691

Tip: Hexagon DIN/ISO 691

Code	SW	L	D1	D2	T		
075040	19	100	35,5	54	21,0	940	1
075042	22	100	40,0	54	21,0	953	1
075043	23	100	41,0	54	21,0	932	1
075044	24	100	42,0	54	21,0	985	1
075045	27	100	46,0	54	23,0	985	1
075047	30	100	50,0	54	50,0	1056	1
075048	32	100	52,0	54	50,0	1065	1
075049	33	100	53,0	54	50,0	1106	1
075050	34	100	55,0	54	50,0	1117	1
075051	36	100	57,0	54	64,0	1096	1
075052	38	100	59,5	54	64,0	1204	1
075053	39	100	60,0	54	64,0	1240	1
075054	41	100	64,0	54	64,0	1273	1
075055	46	100	69,5	54	62,0	1444	1
075056	50	100	75,0	54	62,0	1632	1
075057	55	100	81,0	54	60,0	1699	1
075058	60	105	87,0	54	77,0	2747	1
075059	65	125	93,0	54	80,0	3244	1
075060	70	125	99,0	54	80,0	3623	1
075061	75	135	104,0	86	87,0	3680	1
075062	80	135	109,0	86	87,0	5592	1

### 750 XL Steckschlüssel - extra lange Ausführung

Impact sockets - extra long version





Antrieb: 1" Innenvierkant  
DIN 3121 - H 25

Drive: 1" square

DIN 3121 - H 25

Abtrieb: Innensechskant DIN/ISO 691

Tip: Hexagon DIN/ISO 691

Code	SW	L	D1	D2	T		
075065	24	270	38,5	54	24,0	2299	1
075066	27	270	42,3	54	27,0	2736	1
075067	30	270	46,0	54	30,0	2598	1
075068	32	270	48,5	54	32,0	1670	1
075069	33	270	49,8	54	32,0	1685	1
075070	36	270	53,5	54	32,0	3366	1

\*Sonderanfertigung - Preis auf Anfrage  
Alle Gewichtsangaben sind Zirka-Angaben in Gramm  
Alle Maßangaben sind in Millimeter

\*Non standard product - price on request  
All weights are approx. in gram  
All dimensions are in millimeter



ASW-Schnellwechselhalter, ideal für häufige Werkzeugwechsel  
If you change tools often - choose the ASW quick-release chuck

# Steckschlüssel - Antrieb: H 25 - 1" Innenvierkant

## Impact-Sockets - Drive: H 25 - 1" female square



### 750 DW Steckschlüssel - dünnwandig, lange Ausführung

Impact sockets - thin walled, long version



**Antrieb:** 1" Innenvierkant  
DIN 3121 - H 25  
**Abtrieb:** Innensechskant DIN/ISO 691  
**Drive:** 1" square  
DIN 3121 - H 25  
**Tip:** Hexagon DIN/ISO 691

Code	SW	L	D1	D2	T		
075071	22	108	36,0	53	22,0	790	1
075072	24	108	38,5	53	24,0	810	1
075073	27	108	42,3	53	27,0	865	1
075074	30	108	46,0	53	30,0	910	1
075075	32	108	48,5	53	32,0	970	1
075076	33	108	49,8	53	33,0	990	1
075077	36	108	53,5	53	36,0	1020	1

### 750 VK Steckschlüssel - Vierkant

Impact sockets - square



**Antrieb:** 1" Innenvierkant  
DIN 3121 - H 25  
**Abtrieb:** Innenvierkant  
**Drive:** 1" square  
DIN 3121 - H 25  
**Tip:** Square

Code	SW	L	D1	D2	T		
075090	21x28	108	53,0	54	32,0	1425	1

### 755 Steckschlüssel

Impact sockets



**Antrieb:** 1" Innenvierkant  
DIN 3121 - H 25  
**Abtrieb:** Außensechskant DIN/ISO 2936  
**Drive:** 1" square  
DIN 3121 - H 25  
**Tip:** Hexagon DIN/ISO 2936

Code	SW	L	D2	T		
075506	14	75	54	12,0	580	1
075507	17	75	54	15,0	636	1
075508	19	75	54	17,0	640	1
075509	22	75	54	20,0	649	1
075510	24	75	54	20,0	678	1
075511	27	75	54	20,0	696	1
075512	30	75	54	20,0	807	1
075513	32	75	54	20,0	762	1
075514	36	75	54	20,0	828	1

### 755 H Halter für auswechselbare Einsätze

Adapter for exchangeable bits

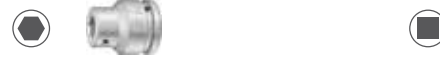

**Antrieb:** 1" Innenvierkant  
DIN 3121 - H 25  
**Abtrieb:** Innensechskant - 22 mm  
**Drive:** 1" square  
DIN 3121 - H 25  
**Tip:** Hexagon - 22 mm

Code	L	D1	D2		
075550	70	44,0	54	788	1

### 755 E Auswechselbare Einsätze

Exchangeable bits



**Antrieb:** 22 mm Sechskant  
**Abtrieb:** Außensechskant DIN/ISO 2936  
**Drive:** 22 mm hexagon  
**Tip:** Hexagon DIN/ISO 2936

Code	SW	L		
075556	14	50	118	1
075557	17	50	131	1
075558	19	50	142	1
075559	22	50	161	1
075560	24	50	174	1
075561	27	50	201	1
075562	30	50	226	1
075563	32	50	244	1
075564	36	50	284	1



### Halter für auswechselbare Einsätze - Abmessungen

Adapter for exchangeable bits - dimensions

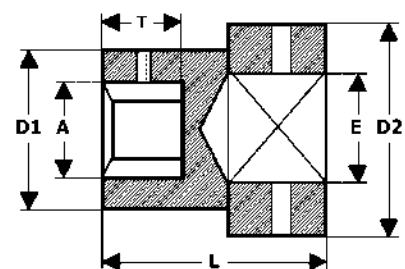

Alle Maßangaben sind in Millimeter - All dimensions are in millimeter

\*Sonderanfertigung - Preis auf Anfrage  
Alle Gewichtsangaben sind Zirka-Angaben in Gramm  
Alle Maßangaben sind in Millimeter

\*Non standard product - price on request  
All weights are approx. in gram  
All dimensions are in millimeter